

NOTES: UNLESS OTHERWISE SPECIFIED

1. MATERIAL:
INSULATOR: PBT or NY-6T
CONTACT: BRASS
2. CHARACTERISTICS:
CURRENT RATING : 3.0A @ 80°C AMBIENT
VOLTAGE RATING : 250V AC,DC
3. OPERATING TEMP RANGE:
-40°C TO +105°C WITH GOLD
4. CONTACT RESISTANCE:
INITIAL: 20m OHM MAX.
AFTER ENVIRONMENTAL TEST: 40m OHM MAX.
5. INSULATION RESISTANCE:
INITIAL: 1000M OHM MIN.
AFTER HUMIDITY AND THERMAL SHOCK TEST: 500M OHM MIN.
6. DIELECTRIC WITHSTANDING VOLTAGE: 1000V AC/MIN
7. MECHANICAL PERFORMANCE:
INSERTION FORCE: 170 GRAMS AVERAGE.
WITHDRAWAL FORCE: 130 GRAMS AVERAGE.
NORMAL FORCE: 125 GRAMS AVERAGE.
8. MAX PROCESSING TEMP:
PBT: 200°C FOR 20 SECONDS
NY-6T: 260°C FOR 10 SECONDS

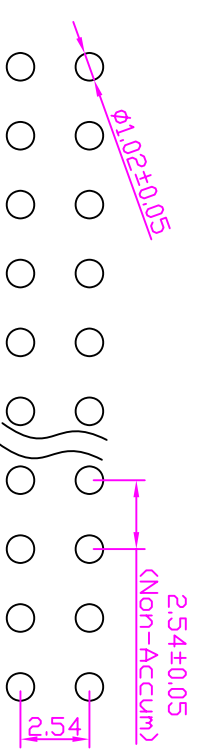
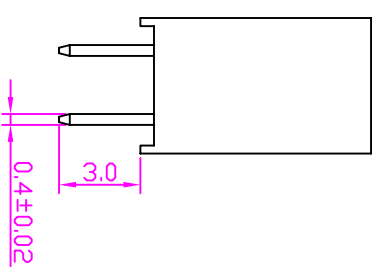
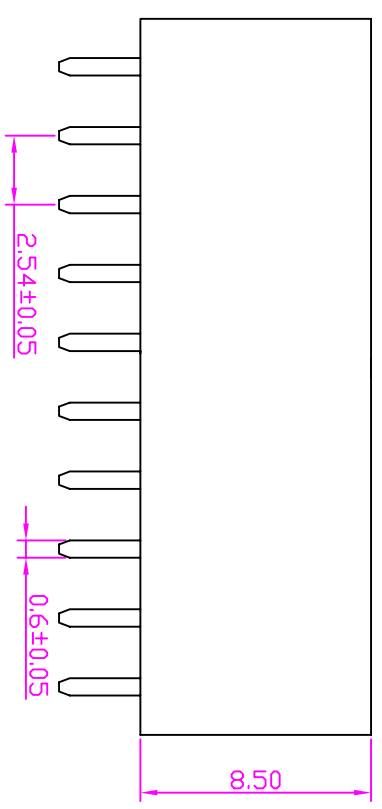
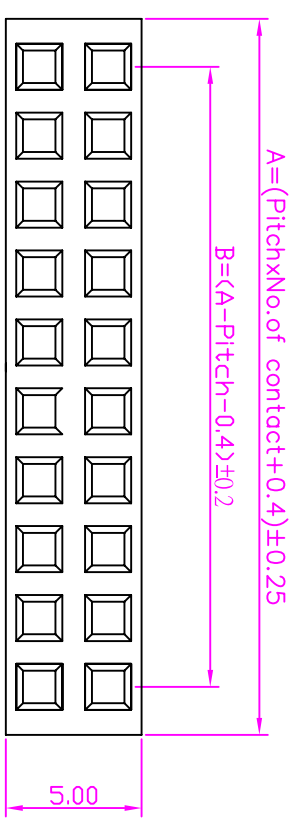

P.C.B LAYOUT

PART NUMBER
CTP - 02AA - 2 X X 0 - 1 1 - 0 2 1

SERIES: TWO ROWS

NUMBER OF POS. PER ROW (02 TO 40 CONTACTS)

0: WITHOUT POST
1: GOLD FLASH
I: GOLD PLATED OPTION
(TAIL PLATED OPTION)
(CONTACT PLATED OPTION)

REV.	A	1227,2005	RELEASE
DATE			
DESCRIPTION			

Connect-Tech Products Corp.
TEL:+1 510 4400578 www.Connect-Tech-Products.com

TOLERANCES	X.X ±0.3 X.XX ±0.2 X.XXX ±0.1 Angle ±5°
TITLE	PIN HEADER RECEPTACLE SERIES 2.54 X 2.54mm PITCH, TWO ROWS PCB MOUNT, H: 8.50mm
DRAWN BY	9896AV
CHECKED BY	97993W
APPROVED BY	01619R
UNIT	MM
SCALE	NONE
SIZE	A4
DRAW NO.	D002-AA021
REV.	A